



**ELECTRICAL INDUSTRIES**



2011 general catalogue 2012

**FPB Palazzoli**

# REEFER CONTAINER



# REEFER CONTAINER

## CONTAINER PRODUCTS

<b>Conformity to Standards:</b>	BS EN 60309-1	IEC 60309-1	<b>Temperature resistance:</b>	Operating	-25 to +50°C
	BS EN 60309-2	IEC 60309-2		Storage	-30 to +70°C
	BS EN 60529	IEC 60529	<b>Cable entry</b>	(Plugs & Connectors) 32A 3P+E	min: 12.5 max: 19.5mm
	EN 60947-3		(Sw. Interlock Skt) 32A 3P+E		M25 Threaded
<b>Impact resistance:</b>	>IK 06		<b>Connecting sections of the wires</b>	32A (Plugs & Connectors)	min: 2.5 max: 6 mm <sup>2</sup>
<b>Glow wire test:</b>	850°C			32A Sockets	min: 2.5 max: 10 mm <sup>2</sup>

### Reefer container

A complete range of watertight (IP67) Plugs & Sockets designed for Container use. Units are in accordance with IEC60309-2, & are rated at 32A.

- A heavy duty product range comprising plugs, connectors, sockets, & switched / mechanically interlocked sockets
- Exclusively designed for reefer container applications
- 32 Amp >380V 50Hz – 440V 60Hz 3 pole + earth (4 pin) rating only
- 3P + Earth with the earth contact in the 3 hour earth clocking position

## PLUGS AND CONNECTORS

### IP67 Watertight - Cee plug



A	V	
32	>380-400	PM32/605RCFPB

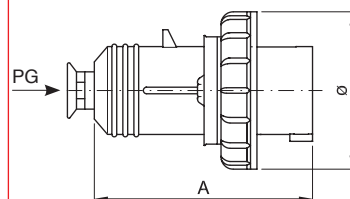

Rated current (A)	Poles	A (mm)	ø (mm)
32	2P+E	141	94
	3P+E	141	94
	3P+N+E	141	101

### IP67 Watertight - Cee connector



A	V	
32	>380-400	473486

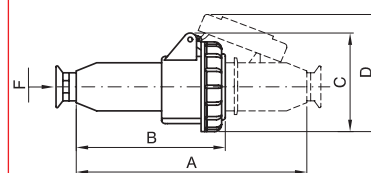

Rated current (A)	Poles	A (mm)	B (mm)	C (mm)	D (mm)
32	2P+E				
	3P+E	328	153	105	125
	3P+N+E			110	130

# REEFER CONTAINER

## SURFACE, PANEL SOCKETS AND INLETS

IP67 Watertight surface socket



A	V	
32	>380-400	PM32/645/RCPFB

- Smooth walls undrilled
- Cable entry possible on all 4 faces plus rear
- Generous wiring space

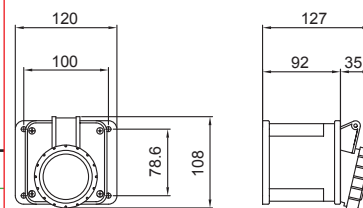

IP67 Watertight topTER panel socket - angled



A	V	
32	>380-400	489223

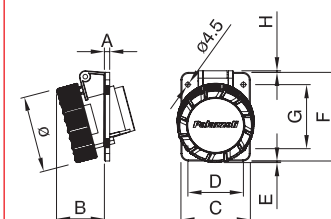

(A)	Poles	mm.						
		A	B	C	D	F	G	ø
16	2P+E	5	45	65	52	60	72	5
	3P+E	5	46	65	52	60	72	80
	3P+N+E	7	47	88	77	100	85	88
32	2P+E	7	54	88	77	100	85	93
	3P+E	7	54	88	77	100	85	93
	3P+N+E	7	55	88	77	100	85	100

IP67 Watertight - Cee appliance inlet



A	V	
32	>380-400	476486

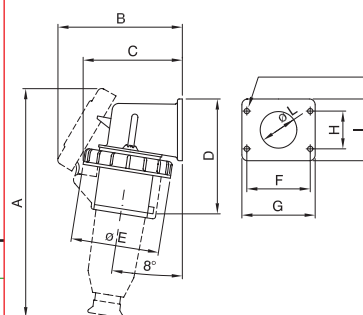

(A)	Poles	mm.									
		A	B	C	D	E	F	G	H	L	
32	3P+E	248	136	108	125	94	68	80	40	66	40

# REEFER CONTAINER

## SWITCHED AND INTERLOCKED SOCKETS

IP67 Watertight - switched and interlocked socket



A	V	
32	>380-400	PM32/3405RC

Can be padlocked in on & off positions

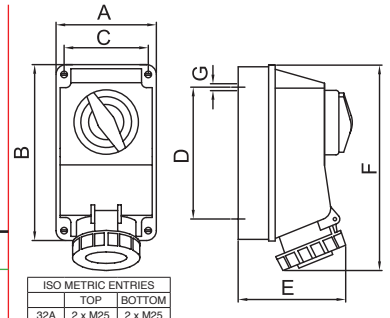

ISO METRIC ENTRIES	
TOP	BOTTOM
32A	2 x M25 2 x M25

(A)	Poles	mm.					
		A	B	C	D	E	F
32	3P+E	122	212	101	171	150	232
							6.5

IP66/67 Watertight - topTER switched interlocked socket



A	V	
32	>380-400	579710

Can be padlocked in on & off positions

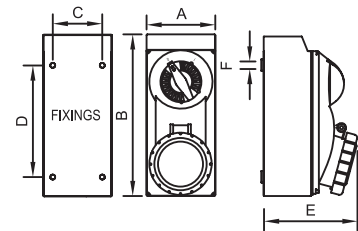

(A)	mm.					
	A	B	C	D	E	F
32	108	260	76	170	148	5

IP67 Watertight - switched and interlocked socket with RCD



A	V	
32	>380-400	PMRCD32/405/SI/RC

Protection at 30mA sensitivity

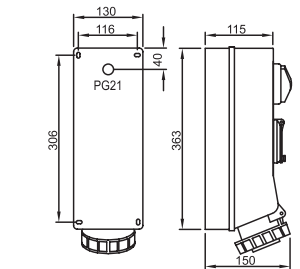

IP67 Watertight - Tais switched and interlocked socket with MCB



A	V	
32	>380-400	474771

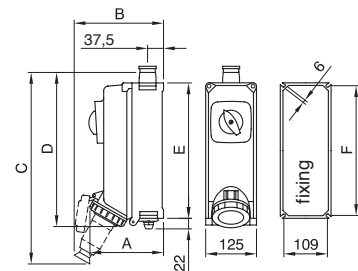

(A)	Poles	mm.					
		A	B	C	D	E	F
32	3P+E	177	213	458	377	335	319

IP67 Watertight - Tais switched and interlocked socket with 4 modules window



A	V	
32	>380-400	472133

- Window allows customer to install their own protective device
- Flying leads from socket & isolation switch to allow ease of installation for protective device

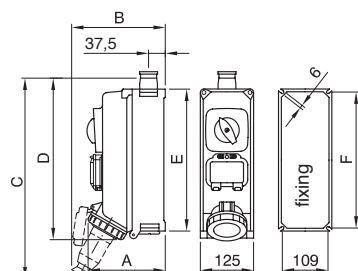

(A)	Poles	mm.					
		A	B	C	D	E	F
32	3P+E	177	213	458	377	335	319

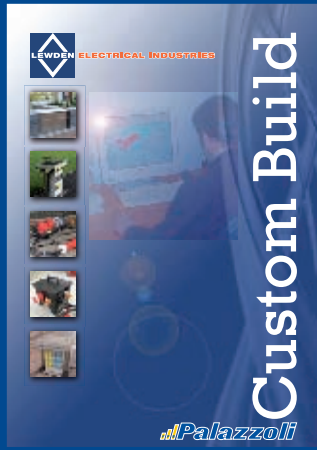

Dealer's stamp



**Argall Avenue, London E10 7QD - United Kingdom**

**UK Sales**

Tel: +44 (0)20 8539 0237  
 Fax: +44 (0)20 8558 2718  
 e-mail: [sales@lewden.co.uk](mailto:sales@lewden.co.uk)

**Export Sales**

Tel: +44 (0)20 8988 7787  
 Fax: +44 (0)20 8558 2001  
 web: [www.lewden.com](http://www.lewden.com)